

General Installation Instructions for Quaker Windows

Please read the following instructions thoroughly before beginning the installation process of the window. The instructions below are intended as a basic guide for window installation, and are general installation details. If you require more in-depth instructions, please contact your Quaker dealer.

Installation of Brighton™ Wood Clad Windows in Frame Walls

- Remove all shipping blocks & cardboard wrapping unless so marked.
- If window is not going to be finished IMMEDIATELY after installing, wrap window in plastic, or paint with primer if you are painting window to avoid warping.
- Be sure your rough opening is level, plumb, and square, and the dimensions are correct (fig. 3). The width and height of your rough opening should be a minimum of 1/2" larger than your window size, but not to exceed 1".
- (fig. 4) Prepare the sill of your rough opening for flashing tape. Make sure that you use the correct flashing tape for your installation application. ‡ Cut a piece of tape (it must be a minimum of 12" longer than the rough opening width). Apply the flashing tape by centering it width-wise on the sill stud and adhering it to the rough opening. Flashing tape should touch the back edge of the sill stud but should not go onto the interior side of the stud. Flashing tape should cover the entire width of the sill stud and should extend at least 6" up each jamb. On the exterior side of the rough opening, the flashing tape should extend approximately 9" downward from the sill stud.
- When installing an operating unit (hung or venting), be sure that the operating sash is closed completely and locked.
- Using a staple remover, pliers, or flat screwdriver, remove the staples that are securing the retractable nailing fin and foam gaskets. Set the foam gaskets nearby for use in Step 14.
- Apply a continuous bead of silicone caulk (3/8" wide) to the following places: a) exterior face of the rough opening except on the sill (fig. 7a) b) backside of the nailing fins except on the sill (fig. 7b)
- Place unit in rough opening from outside, making sure that all 4 sections of nailing fin are standing up. The nailing fin should overlap sheathing.
- Center window in opening. Leave approximately 1/4" of room on each side.
- Find the pre-punched hole in the nailing fin's top right corner. Using roofing nails (minimum of 1" in length), nail the top right corner through the top nailing fin (fig. 10).
- From the outside, center the window in the opening. Shim and adjust so that the window is square and level (fig. 11). Important Note: Thickness for shims should be the same from the inside to the outside to ensure jambs will not bow or "hour-glass".
- Level window and secure opposite top corner with a second nail. Then pull center of window in to measure the same at top or bottom. Again, check the window to make sure it is square and level. If it is not, shim and adjust where needed until the window is level, plumb, and square. An even reveal around the window's frame should be seen.
- Nail the two remaining corners. Note: Units over 36" wide will require blocking under the window sill.
- Place one (1) foam gasket at each corner (fig. 14) to fill the void between the horizontal and vertical nailing fin. The gasket should overlap each nailing fin it contacts, as well as the sheathing. Run a bead of caulk along the entire edge of the gasket (fig. 14a) where it touches the main frame.
- Complete nailing around perimeter. Going around the perimeter of the nailing fin at 8" to 10" intervals, nail the pre-punched holes. DO NOT NAIL EACH HOLE.
- Check the window's operation. Window should work properly if installation is correct. Do not apply interior trim until window works properly. Please note: When adjusting casement windows, it is not uncommon for them to shift during shipment. If operating sash is dragging on top, bottom or sides, there is an adjustment on the hardware to fix this. You will need an adjustment wrench. If you do not have one, they can be supplied by Quaker at the request of your local dealer. There is a metal nut under the operating arm that hooks onto the

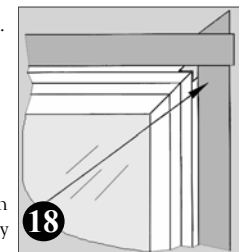
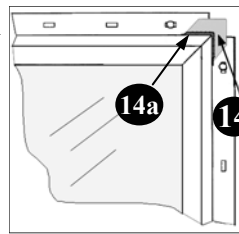
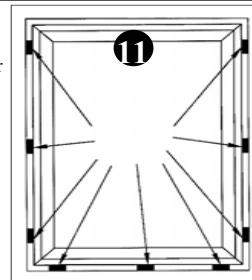
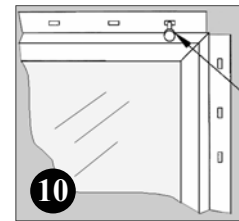
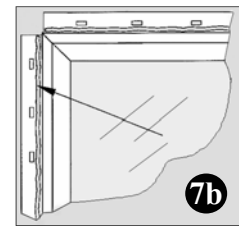
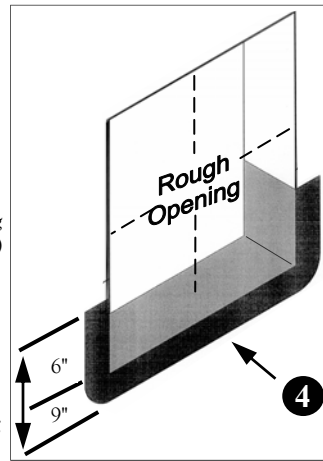
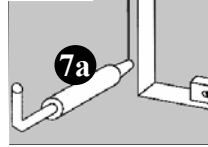
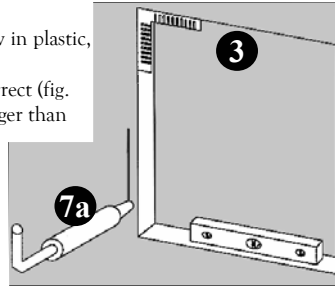

WARNING (Failure to follow these instructions renders all warranties as null & void)

- Store all windows inside. During construction stage of home, do not expose wood interior to moisture, soiling, direct sunlight, temperature extremes or dramatic changes in humidity. Manufacturer assumes no responsibility for defacing, warping, splitting or de-lamination caused by failure to finish properly or faulty installation.
 - Stack windows as straight as possible to avoid bowing. Do not lay flat.
 - Do not drill through window sill to install alarm wires.
 - If using muriatic acid or brick wash cleaning solutions, please follow the manufacturer's instructions found on the product label or on the manufacturer's website.
- Special Note: If broken, glass can fragment causing injury. All Quaker products are available with safety glass. In many areas, local building codes require safety glass in certain locations and/or applications. Unless Quaker's stipulations dictate safety glass or safety glass is specifically ordered, Quaker windows are not provided with safety glass. Before installing, Quaker recommends consulting local building codes for more definitive information.

sash at the top and bottom of the window. Slide the wrench onto this nut and adjust to the left or right to shift the sash into the opening. Find a location that prevents the sash from dragging and still ensure a weather tight seal from the interior.

- On the interior, shim side jambs and jack stud to provide straight true jambs. Window should measure the same in center as at the top and bottom on inside of the house. On wide units, block sill between window sill and rough sill.
- Vertically mulled units require a drip cap before the flashing tape is applied. Flash the nail fins along jambs. Then apply flashing tape to window header last (fig. 18). If properly applied^π, the flashing tape will eliminate water infiltration and ensure a watertight seal. Important note: House wraps must be diagonally cut at the header and must overlap the flashing tape on the header only.
- Place insulation strips (fiberglass or similar) between the window frame and rough opening to eliminate cold drafts. DO NOT OVER-PACK INSULATION. Also, do not use expanding or spray-in type foams. They will distort the window frame, causing operating and performance problems. Doing so will also void any warranty. Caulk around the entire interior perimeter of the window.
- Remove center band at this time.
- Keep siding material 1/4" off the window head, so that pressure will not cause the window head to sag, and possibly damage glass and hinder the window's operation. †If working with masonry or brick applications, see steps below.

^π For application instructions, see your authorized Quaker dealer, or call Quaker Window Products at 573-744-5211.

[‡] When using House Wraps and OSB substrates, or with applications under 45°F (7°C), spray an application adhesive (available at your Quaker dealer) around the perimeter of the window before applying flashing tape. Different applications require different spray adhesives so please check with your dealer for the proper type.

▲ Installation of Brighton™ wood clad windows into Masonry & Brick Veneer Walls

Follow same steps as shown at left but also:

- Allow a 1/4" minimum clearance between the window sill and the brick to allow for expansion and setting.
- Fill the void with silicone caulking.

Quaker Window Products reserves the right to implement design modifications &/or product changes at any time which may cause installation instructions to vary slightly.



A Tradition of Quality Since 1949!



10-06



QUAKER[®]
WINDOWS & DOORS

www.quakerwindows.com